

Barriers and railings

All erected barriers and railings must be respected.

If it is necessary to remove or move barriers or railings, the safety coordinator should be notified, afterwards *you* are responsible for re-establishing these so there is continuous protection against falling.

Work areas with openings in railings must never be abandoned.

Cleaning and tidying

It is important that all craftsmen clean up and removes materials, dust, and tools from the work areas. The clean-up must, as a minimum be carried out after finishing work. When cleaning dusty surfaces, use a swab or vacuum cleaner.

Health and safety plan (HS plan)

Further information about the construction site can be found in the HS plan, which can be found on the information board as well as in the site huts of the Construction Management. Remember it is your duty to know the contents of the HS plan and where it is located.

First aid stations

A first aid station is placed at the site huts and at each end of the building. A procedure for accidents containing important telephone numbers and guidance for first aid is also located there.

Action in case of accident

- Stop the accident and do not expose yourself to danger.
- Provide lifesaving first aid.
- If necessary call **1 1 2**.
- Provide the address for the construction site: **Stensgårdvej 30, 5500 Middelfart**
- Important: Contact Safety coordinator: Flemming Schartau +45 60 20 39 21
- See also the construction site's contingency plans
- Defibrillators are found in the site huts



Waste management

It is important that all construction waste is sorted according to the rules and requirements for the project. Containers have been set up on the construction site for various factions, which appears from signage.

Household waste must be handled properly; this involves storage in accordance with associated signage, in closed containers set up by the site huts.

In connection with the project being BREEAM-certified, it is a requirement that all waste must be sorted in relation to the provided containers with associated signage.

As the project will be DGNB-certified, are the following focus areas in addition to sorting waste:

- Minimize transport of materials/products.
- Prevention and remediation of moisture in the materials.
- Avoid excessive use of electricity and water in the site huts.

Hot work

Remember to report hot work to the construction management when performing the following works.

- Shrinkage of insulation around cables etc.
- Membrane and roofing felt works using open fire
- Cutting and grinding with a grinder
- Welding and torch cutting

Remember to bring your own fire extinguishers which must be located within 5 m of the workplace. Also remember to go on fire duty 60 minutes after finishing work.

Welcome to the construction site T Hansen

A construction site with safety at the centre

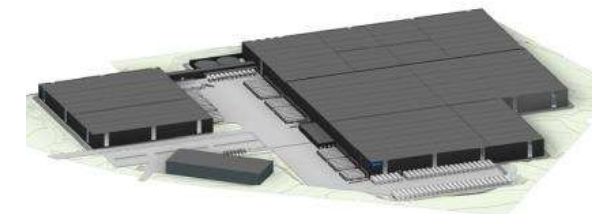

This booklet is handed out to all craftsmen and suppliers who stay or work at the construction site "T Hansen"



DS Flexhal

28-03-2023

Welcome to a safe construction site

Welcome to the construction site **T Hansen**

With this welcome booklet, we will tell you about the rules and guidelines that must be followed when working on the construction site.

Access routes

An information board is placed at the entrance to the site huts. The information board contains an overview drawing of access routes for pedestrians and drivers.

Determine escape routes before commencement of works.

Always secure against fall and stumble on access routes:

- Cables, pipes and materials must always be placed appropriately.
- Holes and protruding items must always be covered or sealed off.

Noise

When making noisy work, always use the most noise-reducing method. For noisy activities between 18.00 – 07.00, the work must be coordinated with the construction management (DS Flexhal) and the OHS coordinator. Reference is made to Middelfart Municipality's noise rules. See also HS plan for the construction site.

Dust

For dusty activities, mechanical extraction must be used. Remember there must always be a discharge to the outdoors with insanitary dust.

Ladders

Avoid ladder work as much as possible: use lift or roll scaffold. When ladder work occurs, there should always be a respect distance to railings corresponding to ladder length + 1 m.

Cutting / grinding with grinder indoors

Remember when working with a grinder you must:

- Establish exhaustion.
- Ensure no other work takes place nearby.
- Ensure that materials or similar cannot be ignited.
- Cover finished floor completely.

Roll scaffolds

At the DSV Hedeland II construction site, all roll scaffolds, regardless of platform height, must have:

- Toprail all the way around the platform at a height of one meter above the platform
- Midrail 50 cm above the platform
- 15 cm high toeboards around the platform

Lift

When using a lift, the work must always be carried out in a safe and secure manner. The following must be ensured:

- Do not run over cables or similar
- The foundation is flat and stable
- The work area is barred; it is your responsibility that there is no one under you when working from the lift
- Straps are used in accordance with the suppliers instructions for use.

Personal protective equipment

When working and commuting on the construction site, an approved helmet, visibility clothing and safety footwear must be used.



Parking

Parking is only allowed in the designated areas:

- Parking in the car park in common area by site huts:
Stensgårdvej 30, 5500 Middelfart
- All other parking takes place in public car parks in the vicinity

Loading and unloading is permitted only on the construction site. Remember to show respect for the ongoing activities on the construction site.

No overnight stays on the site!

Idling

Idling is not permitted on the site.

Deliveries

ALL deliveries must be provided with recipient name and mobile no. The address **Stensgårdvej 30, 5500 Middelfart** can be used to advantage.



If you have any questions, contact: OHS coordinator
Flemming Schartau | Mobile no. 60 20 39 21 | fsc@ds-flexhal.dk

Good work ethic!